

- 1:** APPLY TWO CONTINUOUS ROWS OF US-100 SEALANT ALONG THE EDGE, AND INSTALL STAINLESS STEEL DRIP EDGE ON TOP OF SEALANT. PLACE US-100 SEALANT NEAR CORNER TO RECEIVE PREFORMED INSIDE CORNER.

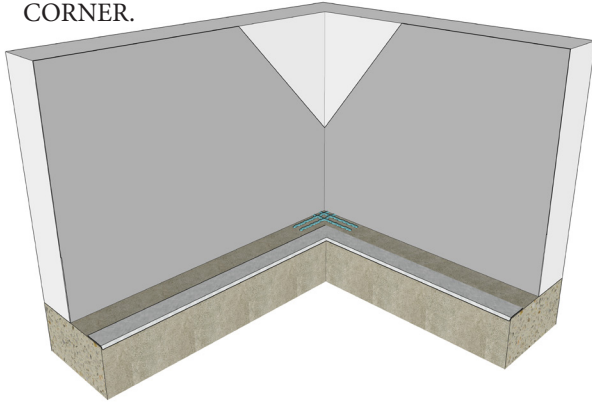

- 2:** APPLY US-100 SEALANT CANT BEADS AT BASE. PLACE PREFORMED INSIDE CORNER ON TOP OF US-100 SEALANT.

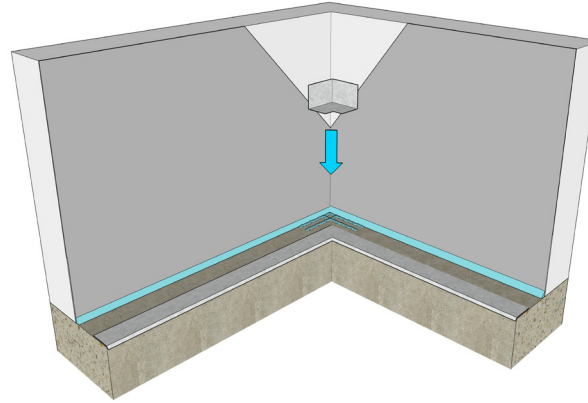

- 3:** SEAL PREFORMED CORNER WITH US-100 SEALANT. APPLY 4" MINIMUM YORK 304 SA SPLICE TAPE O.C. AT LOCATION OF BUTT JOINT.

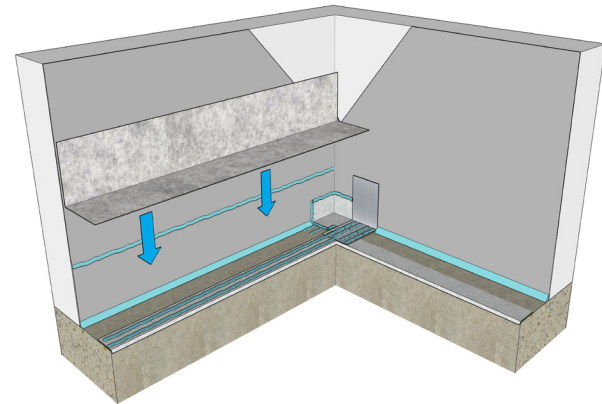
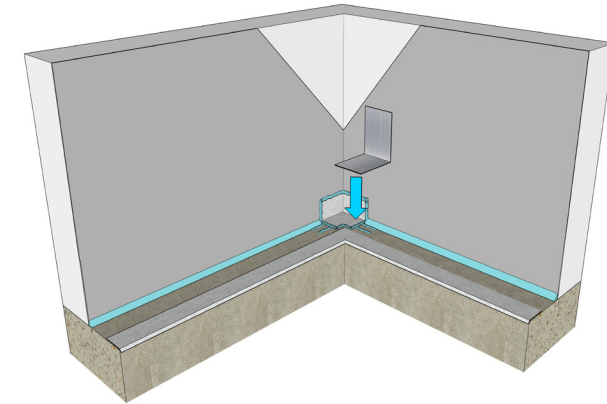

- 4:** APPLY 4 ROWS OF SEALANT ON YORK 304 SA SPLICE TAPE. APPLY 2 ROWS OF SEALANT ON HORIZONTAL PLANE AND AT LOCATION OF TERM BAR TO RECEIVE FLASHING AND TERM BAR. LAY FLASH-VENT COPPER IN PLACE.

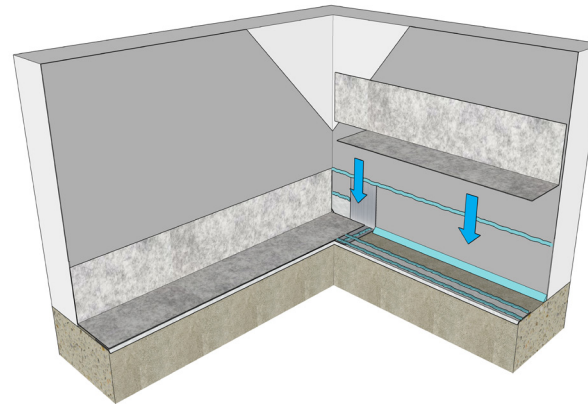

- 5:** APPLY 2 ROWS OF SEALANT ON HORIZONTAL PLANE AND AT LOCATION OF TERM BAR TO RECEIVE FLASHING AND TERM BAR. REMOVE HORIZONTAL PORTION OF FLASHING TO PROPERLY BUTT THE FLASH-VENT COPPER TOGETHER. LAY FLASH-VENT SS IN PLACE.

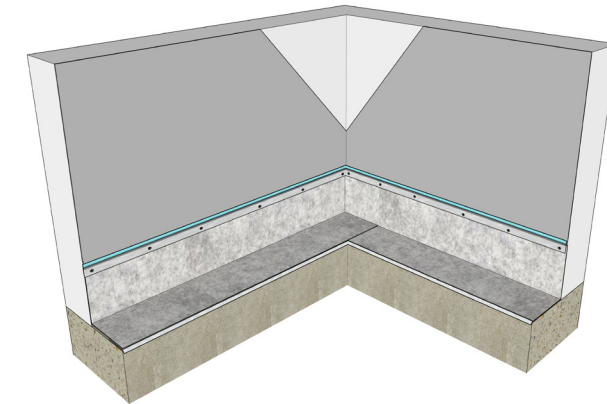

- 6:** INSTALL TERM BAR AND MECHANICALLY FASTEN WITH APPROVED FASTENERS w/ NEOPRENE WASHER @ 8" O.C., AND WITHIN 1" OF EACH END OF BAR. APPLY CONTINUOUS BEAD OF US-100 SEALANT ON TOP OF TERMINATION BAR AND TOOL FOR PROPER ADHESION.

NOTE: FLASH-VENT MUST NOT OVERLAP AT LAPS. JOINING OF DRAINAGE MEMBRANE REQUIRES A 4" MINIMUM SPLICE TAPE AT ALL BUTT JOINTS OF FLASH-VENT. REFERENCE FLASH-VENT LAP DETAILS FOR JOINING OF MATERIALS.

INSIDE CORNER WITH DRIP EDGE DETAIL FLASH-VENT COPPER